

Yurei acoustic panel

Assembly Instructions

Pendant

- 1 Remove the slim metal shade from the top of the LED light panel.

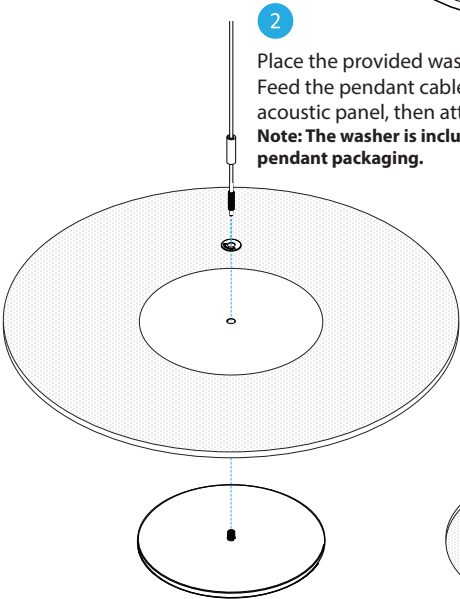
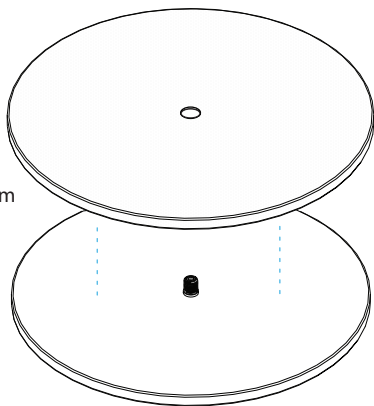

- 2 Place the provided washer on top of the metal shade. Feed the pendant cable through the washer and the acoustic panel, then attach the LED light panel.
Note: The washer is included in the original Yurei pendant packaging.

- 3 Ensure the acoustic panel fully covers the LED light panel. The LED light panel must be completely enclosed within the acoustic panel, with its bottom surface flush with the acoustic panel.

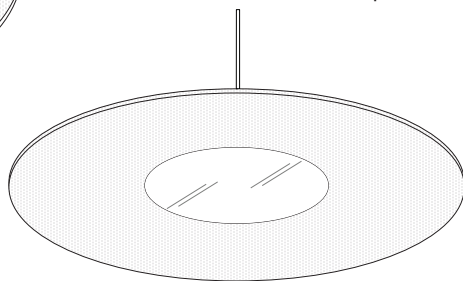

- 4 Tighten the screw cap to securely fasten the pendant cable to the lamp head.

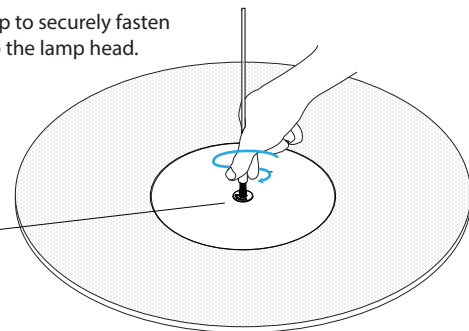
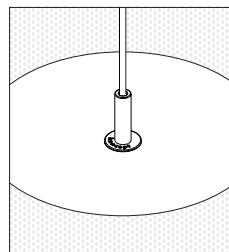

Table / Floor lamp

Remove the slim metal shade from the top of the LED light panel. Place the acoustic panel onto the lamp head. Insert the top cap* labeled (D) into the lamp head and turn clockwise to tighten.
Note: The top cap is included in the original Yurei table / floor lamp packaging.

