

Yurei acoustic panel

Assembly Instructions

Pendant

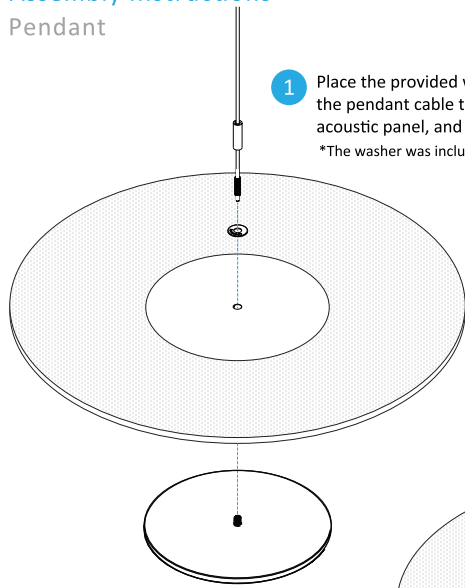

- 1 Place the provided washer on top of the shade, feed the pendant cable through the washer*, then the acoustic panel, and then connect to the lamp head.
*The washer was included in the original Yurei pendant packaging.

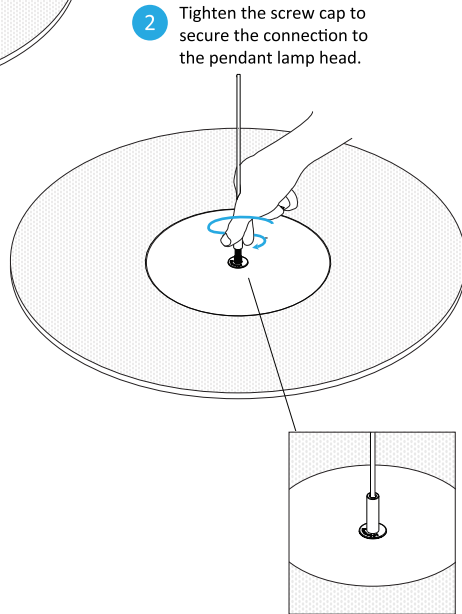

- 2 Tighten the screw cap to secure the connection to the pendant lamp head.

Table / Floor lamp

First place the acoustic panel on top of the lamp head, insert top cap* labeled (D) to the lamp head and then turn clockwise to tighten.

*The top cap was included in the original Yurei table / floor lamp packaging.

