

Shock Hazard. Electric shock could result in serious injury or death. Make sure circuit breaker is set to OFF before installation. Must be installed by a qualified electrician.

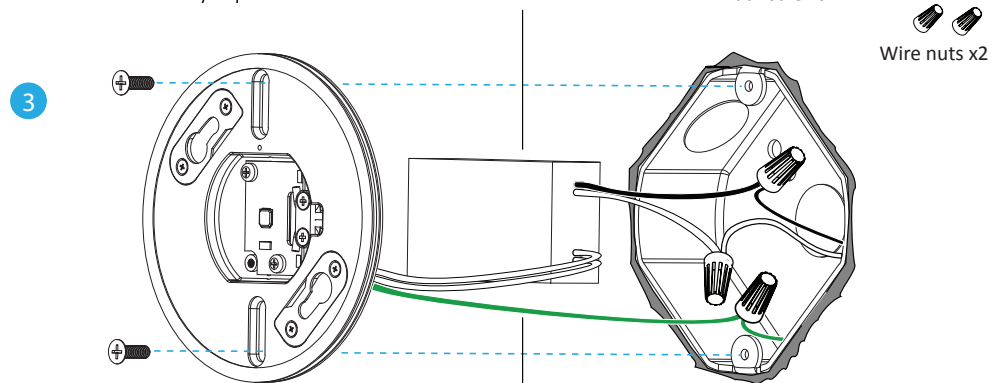

Using the provided wire nuts, connect the Live (black) wire to the Live wire from the mains, the Neutral (white) wire to the Neutral wire from the mains, and the Ground (green) wire to the Ground wire from the mains. Enclose the LED driver inside the wiring box. The wiring (junction) box must be large enough to accommodate the LED driver (2 3/4" x 1 5/8" x 7/8"). The following wiring boxes have been tested and confirmed to be compatible with this installation:

- 4" W x 1 1/2" D octagon box
- 18 cubic inch round retrofit box
- 15.8 cubic inch 4" round weatherproof box
- 4" H x 2 1/8" W x 2 1/8" D single-gang outlet box

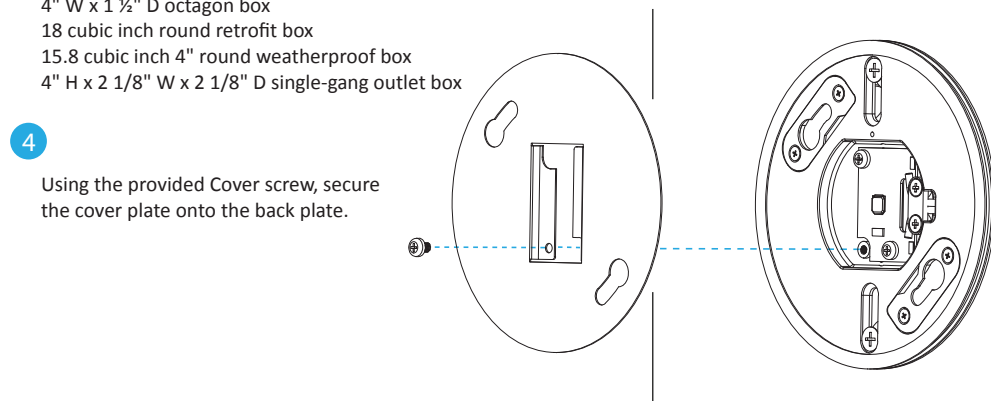

Using the provided Cover screw, secure the cover plate onto the back plate.

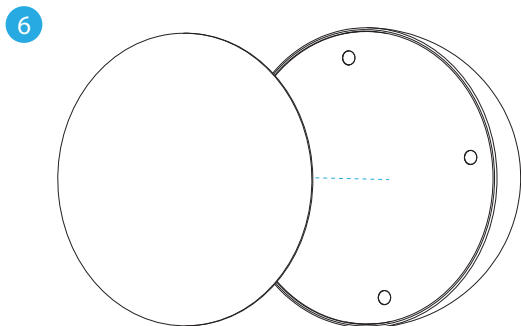
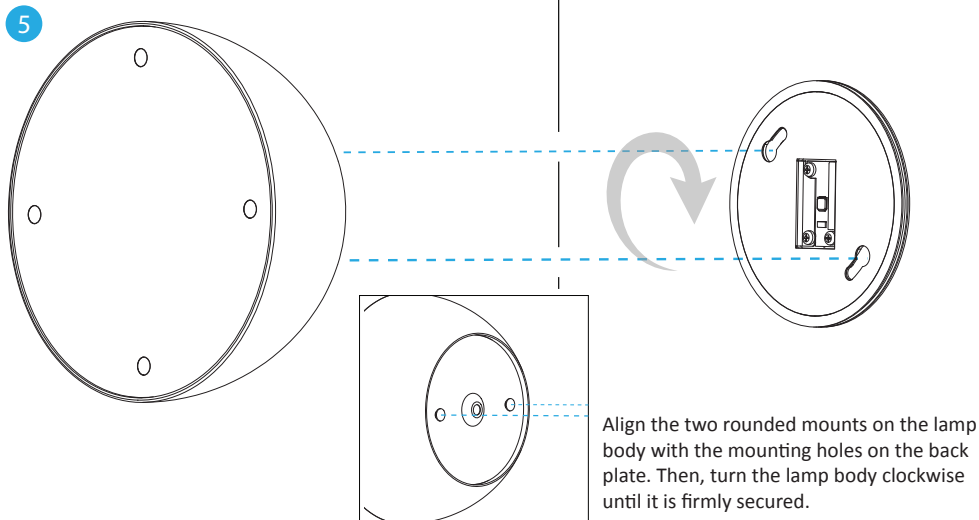

Finally, magnetically put on cover plate.

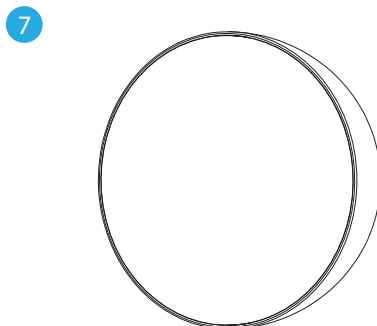

Installation complete.

Model	RMW-06
Light Color	Soft warm
Light Temperature	3000 K
Dimmer compatibility	See: koncept.com/dimmers

Register your Koncept LED lamp online and receive:

- One Year Warranty Extension
- Priority Product Servicing

Visit www.koncept.com/productsupport and enter your serial number (S/N: XXXXXXXX) located on your product.

Warnings



Warning: To reduce the risk of fire, electric shock or injury:

- Do not handle plug or appliance with wet hands
- Do not stare directly at LEDs



Overheating may result in reduced LED lifespan:

- Remove plastic bag from lamp before use.

Koncept Inc.
429 E. Huntington Drive
Monrovia, CA 91016, USA
Phone: 323-261-8999
Fax: 323-261-8998
support@koncept.com
www.koncept.com