

Yurei pendant

Assembly Instructions Flush mount

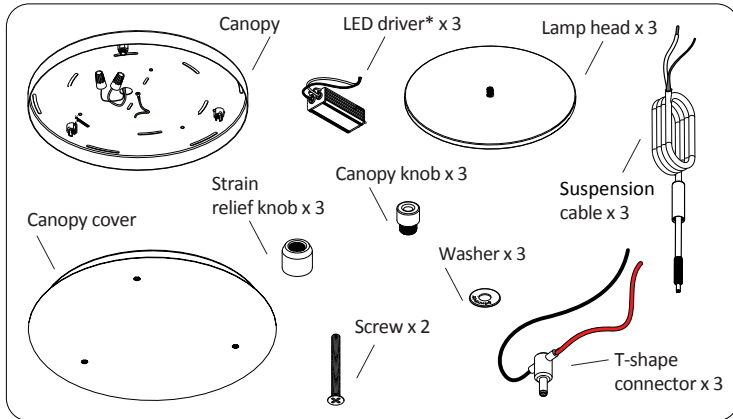

For video instructions, or instructions in other languages, please scan the QR code, or visit www.koncept.com/Yurei



* LED drivers are inside the single unit canopy included with each pendant

1

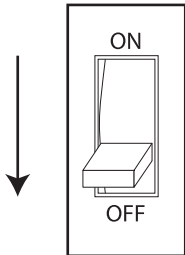

*Your circuit breaker may look different.



Shock Hazard. Electric shock could result in serious injury or death. Make sure circuit breaker is set to OFF before installation. Must be installed by a qualified electrician.

2

Before putting the canopy up, secure the LED drivers to the canopy using provided screws and nuts. Double-sided tapes are supplied to assist with this step.

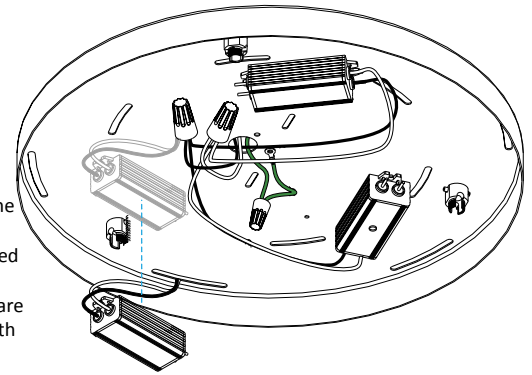

3

Secure the Canopy using the provided screws at the center.

4

Connect all 3 sets of Hot, Neutral and Ground per illustrated and affix LED drivers to the junction box. Further support the canopy by evenly screwing on supporting screws.

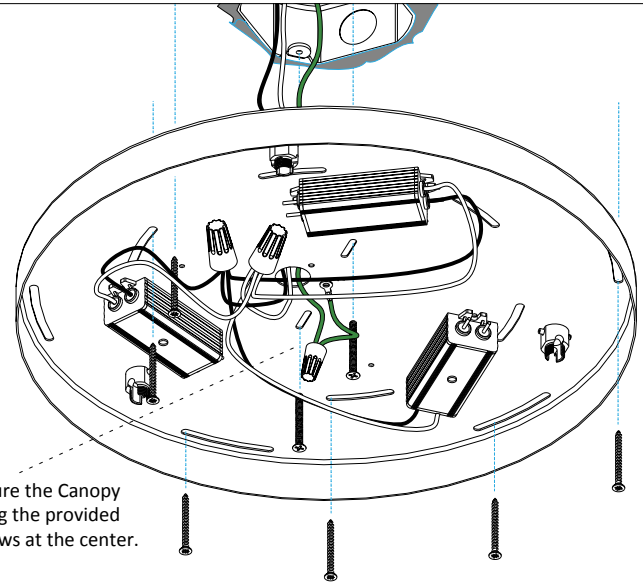

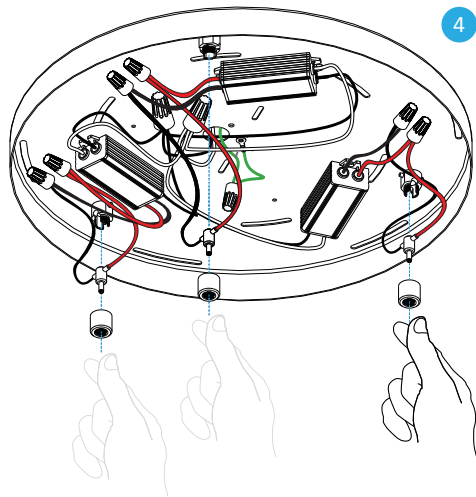

4 Connect the T-shape connectors to the LED driver by connecting the red and black wires to the LED driver respectively. Place it in the receiving holder in the canopy, and screw in Strain relief knobs to hold them in place.

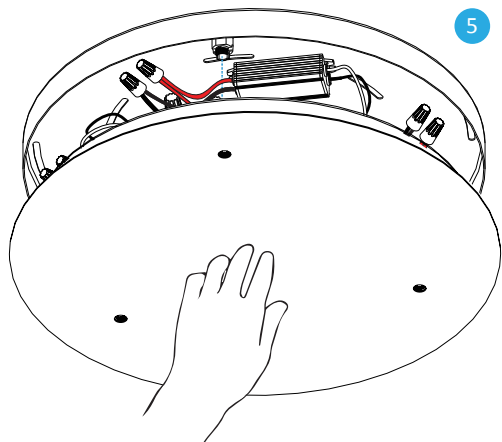

5 Use your hand to hold the canopy cover to the canopy, aligning the 3 holes to the 3 connectors.

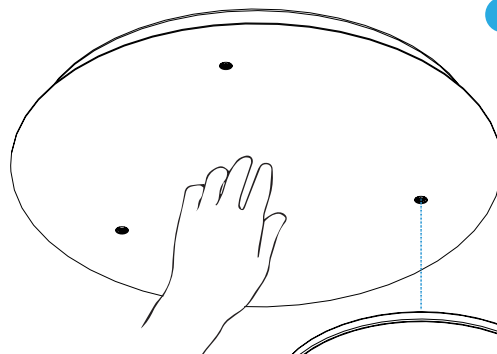

6 With one hand holding the canopy cover, start screwing on the three LED heads to the three the connectors.

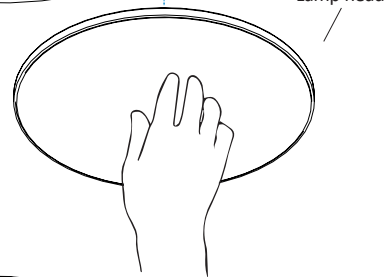

7 Make sure all three lamp heads are fully screwed on. (Do not overtighten)

